

SALES DRAWING SALES DRAWING

SALES DRAWING SALES DRAWING

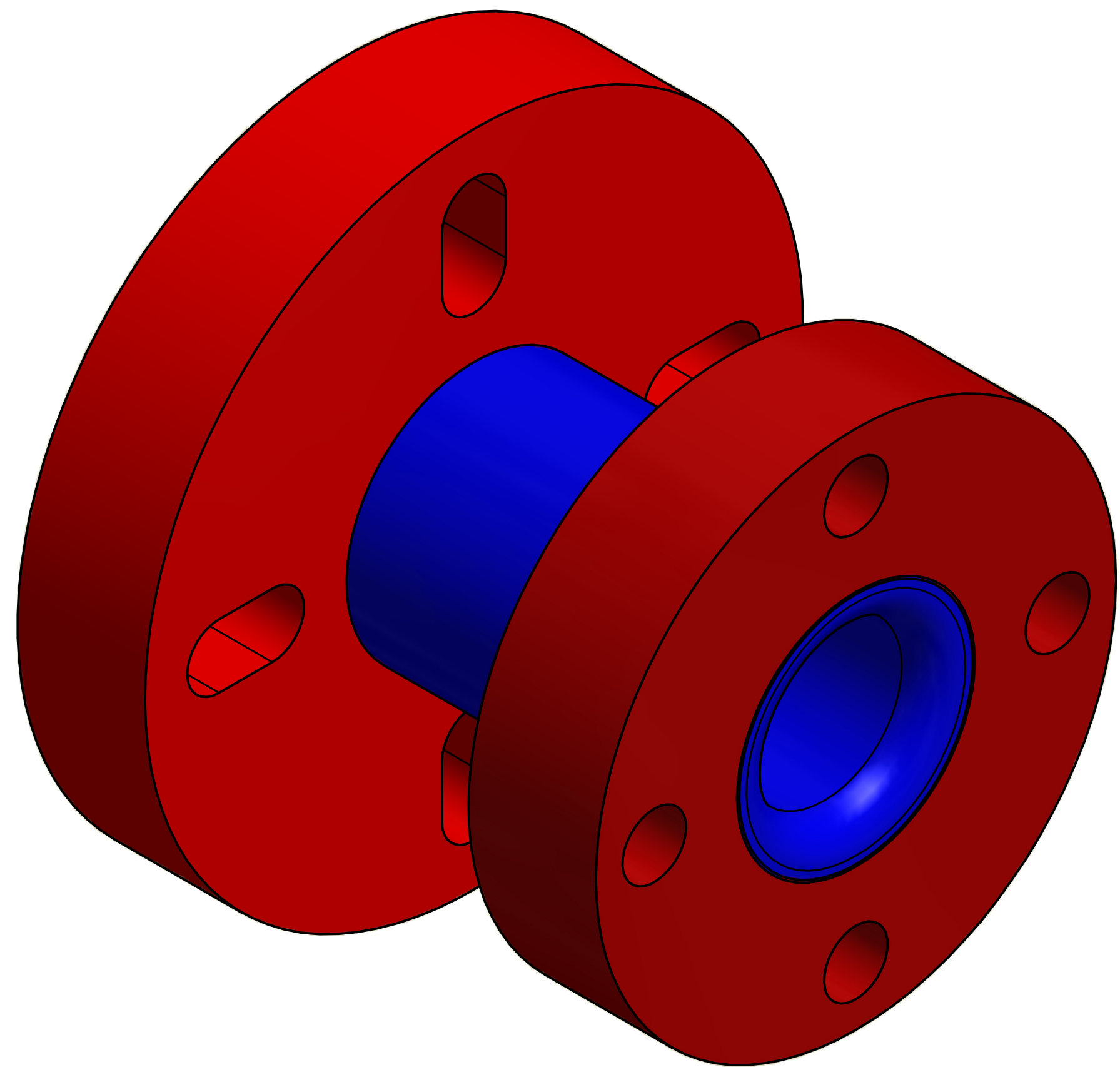
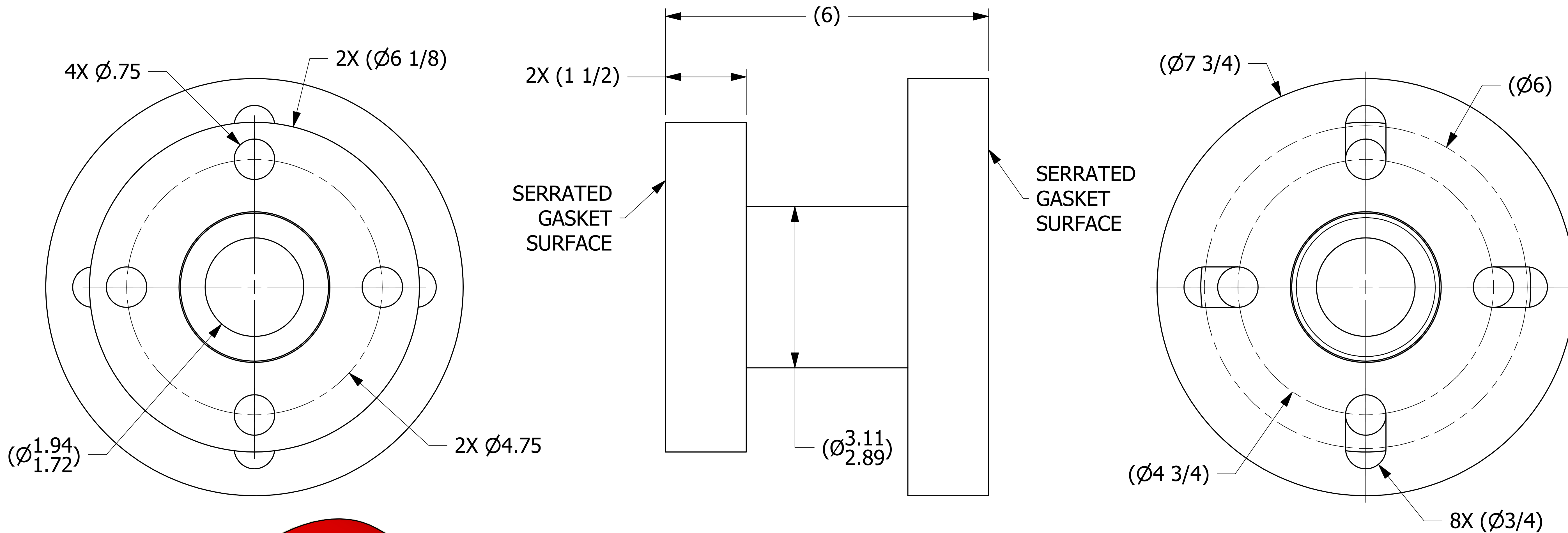

ISOMETRIC VIEW

THIS PRINT, PROPERTY OF SALCO PRODUCTS INC. CONTAINS PROPRIETARY INFORMATION AND MUST NOT BE COPIED, REPRODUCED, OR USED DETRIMENTALLY TO OUR INTEREST.

UNLESS OTHERWISE SPECIFIED  
DIMENSIONAL TOLERANCES  
FRACTIONAL: ±1/16  
X.XX: ±.03  
X.XXX: ±.015  
ANGULAR: ±1°  
DEBURR ALL SHARP EDGES.  
ALL MACHINED SURFACES TO  
HAVE A 125 RMS FINISH  
UNLESS NOTED OTHERWISE.

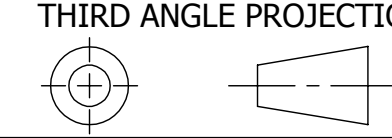

DRAWN BY:	JG
CHECKED BY:	CHL
PROTOTYPE BY:	JG
PROTOTYPE DATE:	9/9/2015
APPROVED FOR PRODUCTION BY:	TAK
PRODUCTION DATE:	10/29/2015

A	TAK	10-29-15	RELEASED FOR PRODUCTION
REV	BY	DATE	DESCRIPTION
<b>SALCO PRODUCTS, INC.</b>			
PART NAME: <b>PIPE SPOOL 2"X3"-2"</b>			
MATERIAL: <b>SALCO PE</b>			
PROJECT #:	H150908F2	SHEET #:	1 OF 1
DRAWING #:	D42311	PART #:	HSSP3X2FP01
			SCALE: 1:1